

ASTROSYN HYBRID STEPPER MOTOR MODEL MY103H702

Specification

Step Angle: 1.8 ° Full Step
 Insulation Resistance: 100 M Ohm Min (500V DC)
 Insulation Class: Class B
 Rotor Inertia: 260 g cm²
 Mass: 0.6 Kg
 Detent Torque: 40 mNm
 Shaft: 6.35mm with D-Cut



Specification Connection	No of Phases	Resistance per Phase ohm $\pm 10\%$	Inductance per Phase mH $\pm 20\%$	Rated Current A	Rated Voltage V	Holding Torque Nm Min
Unipolar	4	6.2	10	1	6.2	0.8
Bipolar Parallel	2	3.1	10	1.4	4.34	1
Bipolar Series	2	12.4	40	0.7	8.68	1

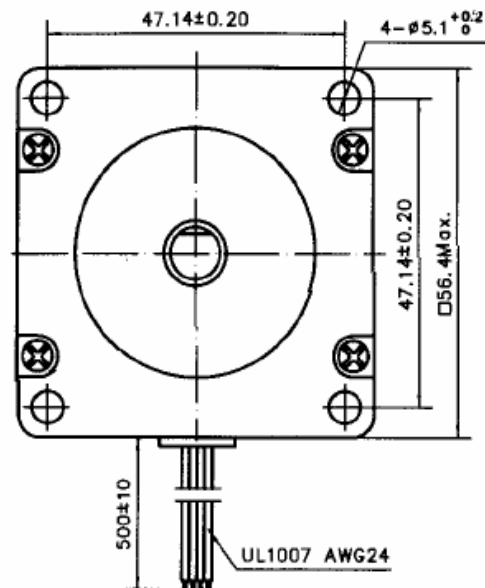
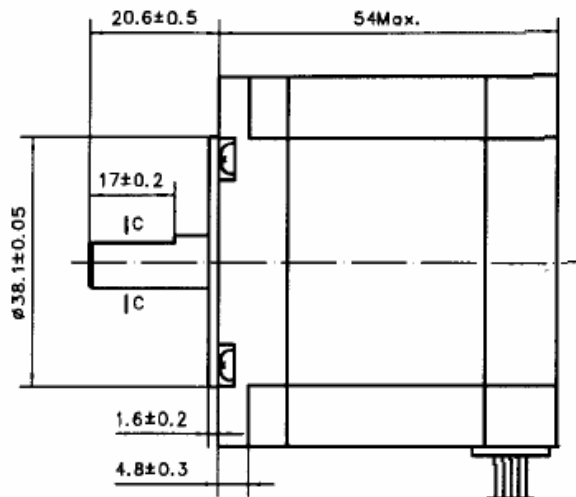

Detail of C-C:

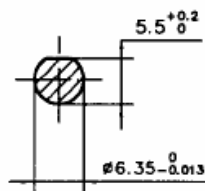

CONNECTION DIAGRAM

1. UNI-POLAR

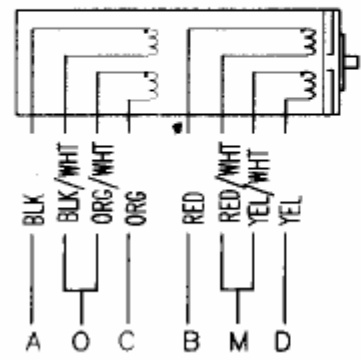

2. BI-POLAR PARALLEL

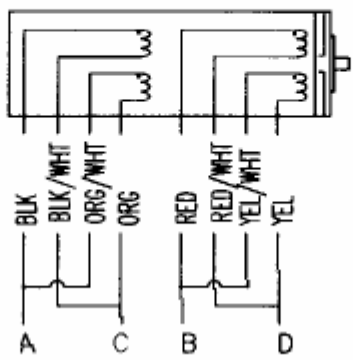

3. BI-POLAR SERIES

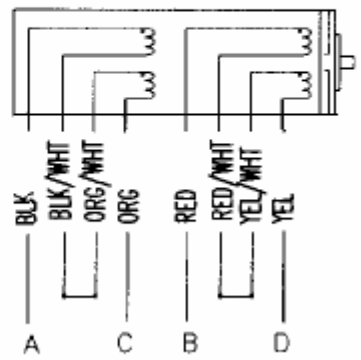

DRIVE SEQUENCE MODEL

1. BI-POLAR FULL STEP

STEP	A	B	C	D	
1	+	+	-	-	<div> <div>CW</div> <div>CCW</div> </div>
2	-	+	+	-	
3	-	-	+	+	
4	+	-	-	+	

2. UNI-POLAR FULL STEP

STEP	A	B	C	D	O	M	
1	-	-			+	+	<div> <div>CW</div> <div>CCW</div> </div>
2		-	-		+	+	
3			-	-	+	+	
4	-			-	+	+	

CW (CLOCKWISE) & CCW (COUNTER CLOCKWISE) ROTATION
WHEN SEEN FROM THE FLANGE SIDE OF THE MOTOR

WIRING DIAGRAM

